OPERATION MANUAL

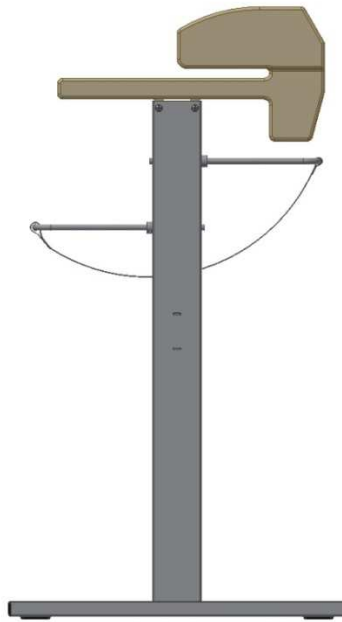

Table of contents		Page
1.0	Safety remarks	2
2.0	Technical data	5
3.0	Installation Instruction	
3.1	Assembly Floorstand	6
3.2	Assembly roll-off device (option)	8
3.3	Assembly stopper (option)	9
3.4	Assembly table height adjuster	10
4.0	Set-up	
4.1	Set-up	11
4.2	Connection of machine	11
4.3	Switch-on	11
4.4	Materials cuttable	12
5.0	Cutting	
5.1	Cutting	13
5.2	Guiding plate	14
6.0	Trouble Shooting	
6.1	Alignment of cutting blade	15
	Wiring diagramme	16

Technical modifications reserved

1.0 Safety regulations

- Read operation manual with safety notes before assembly and commissioning
- Make sure that each operator is aware about this manual
- Always keep this manual near the machine
- **Never ever short cut and mechanical or electrical separation switches**
- Make sure that the supply voltage is in accordance with the voltage indicated on the rating plate of the machine
- Do not remove any fixed screwed parts
- Make sure that no other parts will get into the machine
- **Before each intervention into the mechanical or electrical section of the machine always separate the system from the power supply**

Pull power plug!

- **Make sure that this plug may be reached easily and without any danger!**

1.1 Safety data sheets

Rejection of liability

The following rejection of liability applies to all safety data sheets contained herein. This safety data sheet was compiled to the best of our knowledge and serves as a comprehensive instruction manual for safe operation of this product.

We reserve the right to up-date all data sheets, if new information becomes valid. It is the task of the respective operator to judge on the aptitude for these informations for the compliance with safety measurements.

In case of doubt, the operation must contact the manufacturing company in order to assure himself that the safety data sheet received is in accordance with the latest technical information available. If and to which extent a restriction of liability, according to the applicable law, is permissible, we do not take any responsibility for possible inaccuracies contained in this documentation.

1.2 General

Warranty works will, as a matter of principle, only be performed by ourselves or our authorized expertized dealers.

Have all maintenances and fixings done by the service in charge.

1.3. Dangerousness of this product

This machine has been designed and built, according to the latest standards of technology as well as the approved rules of technology. Nonetheless, there might occur danger for the health of the operator or real values when using this product. This machine is only supposed to be used for those functions described in this operation manual. Malfunctions which might affect safety must, therefore, be removed instantly.

All persons engaged with the set-up, commissioning and maintenance of this machine, must be qualified accordingly and strictly follow the instructions of this operation manual.

This is for your own safety!

1.4. Remarks concerning safety and tips

In this operation manual, menacing dangers are described.

CAUTION: If not complying with these remarks, injuries might result!

1.5. Use as directed

This cutting machine is exclusively designed for cutting of media, defined in regard to their nature and their features in continuation under paragraph 4.4 (materials cuttable). Any other or additional using methods are not be viewed as directed. The manufacturer will, therefore, not be liable for any damages arising from such usage not recommended. This risk will be borne by the user exclusively.

IMPORTANT: Part of this usage as directed is also to follow all remarks outlined in this operation manual. Unauthorized modifications of this machine result in a complete refusal of any liability on the part of the manufacturer for damages arising from such modifications.

IMPORTANT: This machine must not be used in explosion-endangered surroundings.

1.6. Emission

The A-proved equivalent continuous sound pressure level of the machine is below the allowed emission values. Emission of any other kind are not produced by this machine.

1.7. Sources of danger

As a source of danger, the area of the circular blade needs to be mentioned. When complying with the remarks pointed out in this operation manual, no injuries may result.

1.8. Safety measurements at the site of installation

Sufficient illumination needs to be ensured at the working place.

CAUTION: Before starting maintenance or fixing works as well as when putting this machine out of operation for a longer period of time, the mains plug must be pulled out so to ensure that the machine will not be put back into operation unauthorizedly.

1.9. Safety set-ups

This machine can be switched off at any time by pushing the main switch.

IMPORTANT: This machine may only be operated by persons who are authorized to do so and who are able to perform all works on their own independently or who will be being supervised when working with this machine. The owner must make this operation manual available to any operator and make sure that each operator has taken note of and understood the contents of this manual.

No personal safety equipment required.

2.0 Technical data

Space required for installation:	appr. 0,85 m ²
Weight:	appr. 50 kg
Supply voltage:	230 V, 1NAC, 50/60 Hz
Nominal current:	0,6 A
Supply voltage:	115V, 1NAC, 50/60 Hz*
Nominal current:	1,2 A *
Connection value:	140 VA
Sound pressure level	appr. 65 dB(A)
Cutting speed:	appr. 1,5m/s
Dimensions:	1750 x 990 x 450 mm 2250 x 990 x 450 mm (Width x Height x Depth)

* optionally available

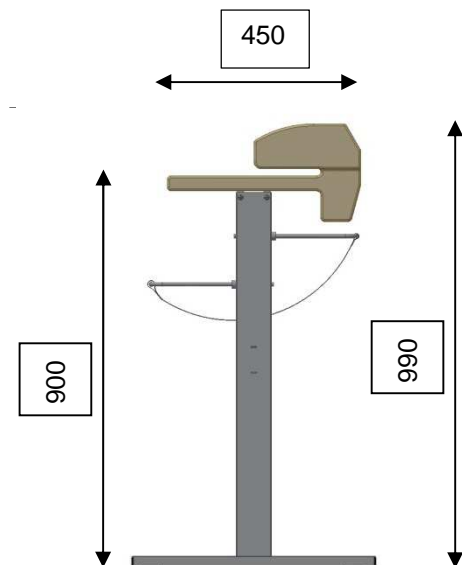
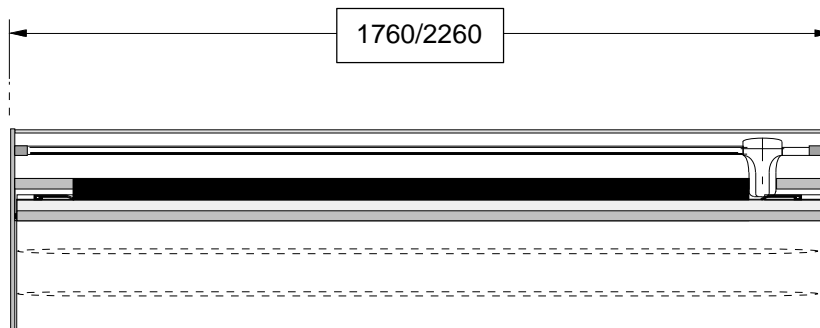

3.0 Installation Instruction

Unpack cutter and all parts of stand.

Important: Please, strictly comply with the instructions described in continuation when mounting the stand.

3.1 Assembly Floorstand

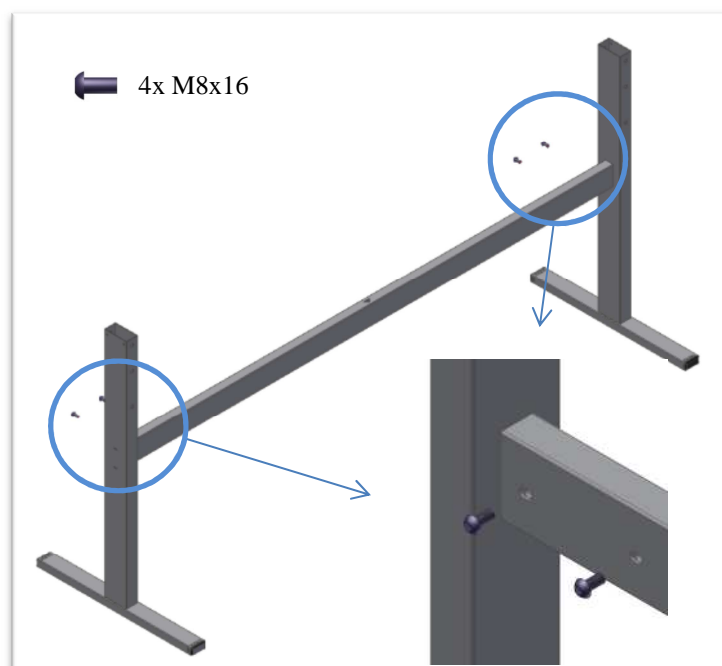
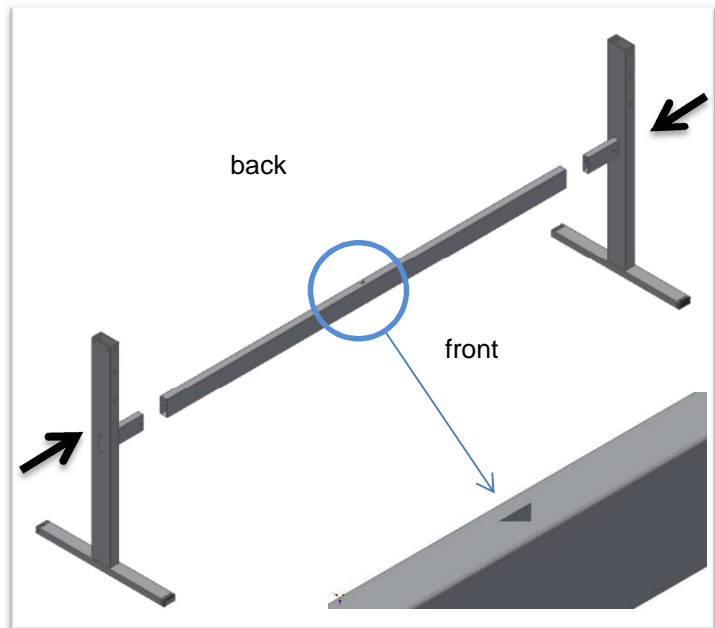

3.2. Assembly roll-off device (option)

- 1) holding traverse (2x)
- 2) paper rod
- 3) stopper (2x)
- 4) knurled screw M6x35 (4x)
- 5) oval head screw M4x8 (2x)
- 6) serrated lock washer J 4,3 (2x)

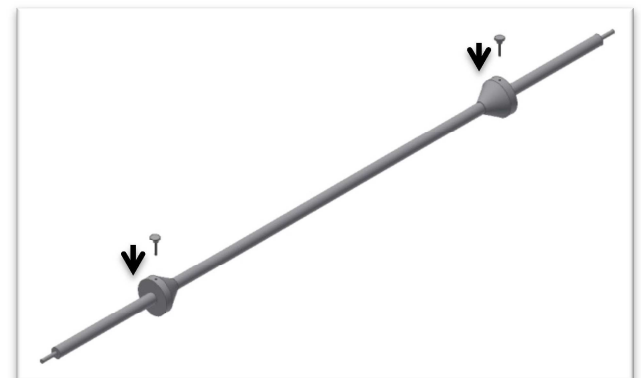
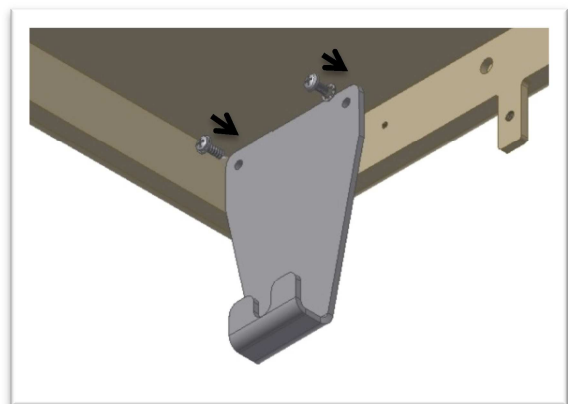
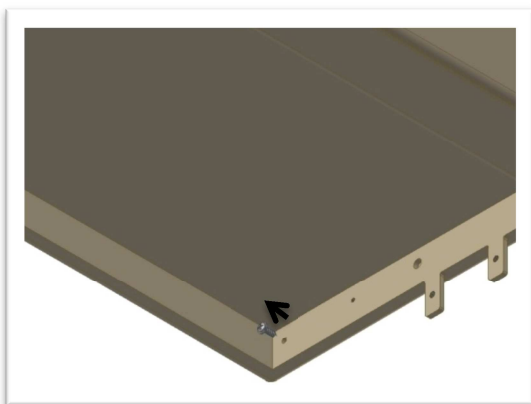
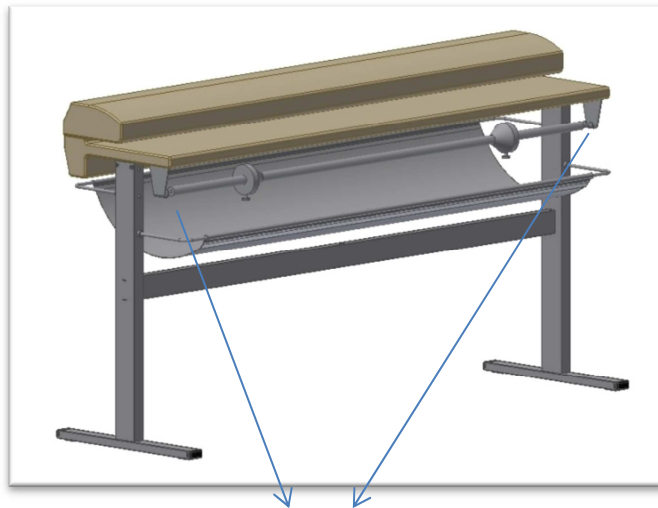



3.3. Assembly stopper (option)

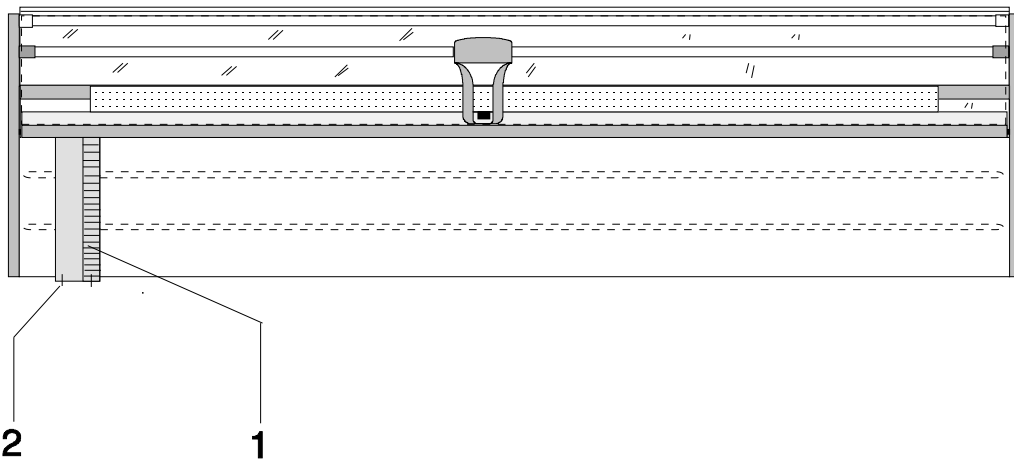

components:

List of

- 1) stopper
- 2) oval head screw M6x12 (2x)

- A) Put the stopper (position 1) onto the table profile.
- B) Push the hexagon nuts inside the table profile into position.
- C) The stopper is formed at its rear side in a way that they may locked angularly into the position desired in the sunked nute of the table profile.
- D) Fix the stopper with the over head screws (position 2).

3.4. Assembly table height adjuster (option)

List of components:

- 1) adjusting plate (2x)
- 2) thread rail (4x)
- 3) screen surround left and right
- 4) flat head screw M6x12
- 5) screw M6x10 (4x) -- (part of delivery of serial machine)

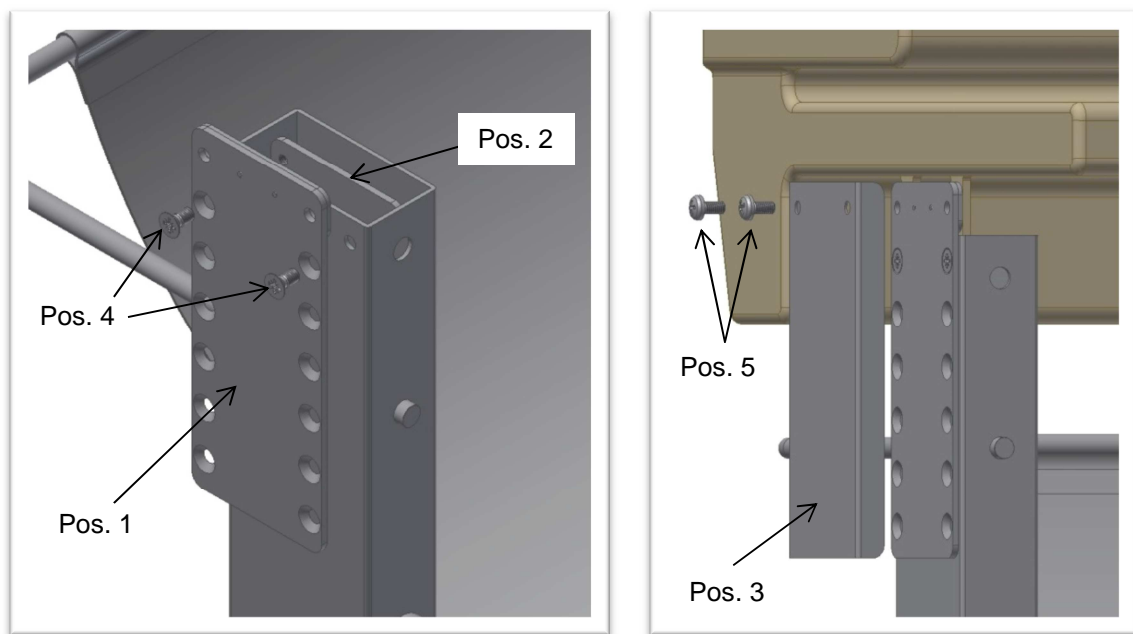

In order to make an individual height alignment of the machine possible, an optional device for adjusting the table height is available. The working height can be adjusted in steps of 25mm each.

- A) Screw the adjusting plates (position 1) with the flat head screws (position 4) by means of the thread rail (position 2) to the stand. For doing so, there are passage holes bored inside of the stand.**
- B) Make sure that the adjusting plates (position 1) will be mounted in a way that the distance brackets marked with points will be in upward direction, pointing to the middle to the stand.**
- C) Push the screen surround (position 3) from the outside over the adjusting plates, so that the passage holes will be pointing upwards and be equal with the bore holes of the adjusting plates in the section of the distance brackets marked.**
- D) Fix the machine with the oval head screws (position 5), as described under paragraph 3.3. page 6, to the stand. 2 persons are necessary.**

4.0 Set-up

4.1 Set-up

The machine must stand horizontally and on solid ground.

Do not put cutter with its back side to the wall. Keep a distance so that the plexi glass cover may be opened sufficiently.

4.2 Connection of machine

Check beforehand whether the supply power corresponds with the voltage indicated on the rating plate.

4.3 Switching on

The power plug for the cutter drive and the illumination is positioned beneath the left table plate. Controlling lamp will light up in on-position.

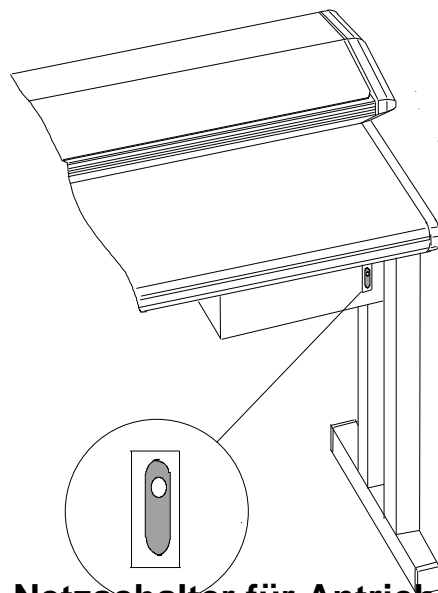

Netzschalter für Antrieb und Beleuchtung
Power plug for drive and illumination

4.4 Cuttable materials

Do not process any crushed, curved, demolished or humid masters.

Note: To avoid malfunctions, the following instructions should be strictly complied with:

- during the cutting process, the master must not be moved
- hold master at its outer edges

The following materials may be cut electrically:

- | | |
|------------------------|---------------------------------------|
| ● Paper types | plain paper 55 - 250 g/m ² |
| ● PE / foil | max. 0,5 mm strong |
| ● transparent material | max. 250 g/m ² |
| ● carton | max. 0,5 mm strong |
| ● laminate | max. 0,5 mm strong |
| ● metal foil | depends on nature of material |

Humid or wet materials must not be cut.

5.0 Cutting

5.1 Cutting process

- The cutting process will be performed electrically.
- Push master to cutting edge
- Fix requested cutting edge
- Hold master with both hands on top of the table and push paddle or rupturing ridge
- The cutting head will cut the paper stripes

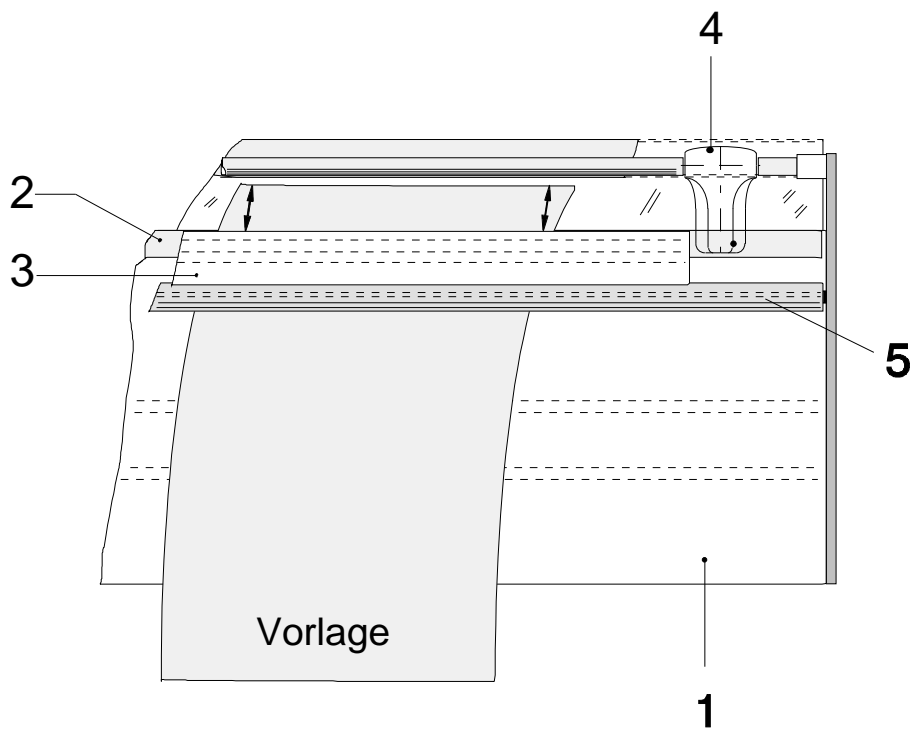

- | | | |
|------|---|---------------------------------------|
| Pos. | 1. Tischplatte / <i>Table</i> | 2. Untermesser / <i>lower blade</i> |
| | 3. Niederhalter / <i>pressure pad</i> | 4. Scheidekopf. / <i>cutting head</i> |
| | 5. Schaltleiste / <i>switching gib profil</i> | |

5.2. Guiding plate

A. Cutting of single masters

- For cutting of single copies, position guiding plate perpendicularly by means of the operating lever (right hand side of machine).
- Paper strips cut will be falling downwards into the collection bag.

B. Cutting of paper web

- For cutting of paper webs, position guiding plate horizontally by means of the operation lever (right hand side of machine).
- The material cut will be transported backwards through the collection bag.

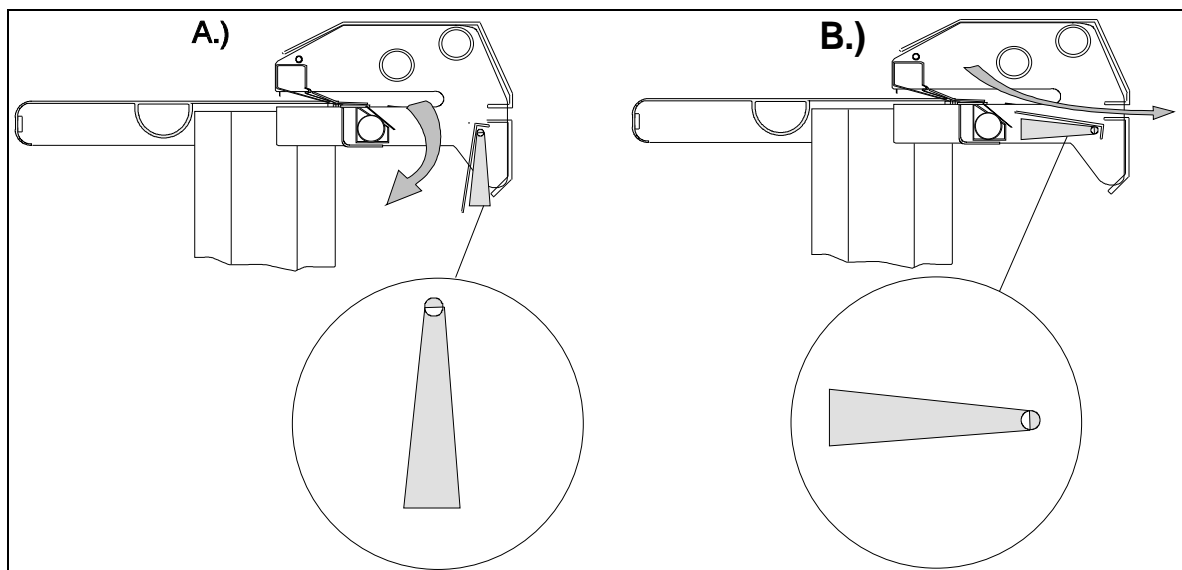

6.0 Trouble Shooting

6.1 Alignment of cutting blade

If the cutting blade (circular blade) has run onto the lower cutting blade, it may be aligned again with the help of the mounting tools.

- Open upper cover and push the cutting head towards the middle of the machine.
- Move cutting head to the middle of machine and move revolving blade backwards by pressing button on axle of revolving blade.
- Simultaneously, the cutting head should be pushed backwards manually with the other hand.
- Bending of the guiding tubes favours the alignment.

Caution: The plain bearing rail in the section of the cutter head's guiding rods must not be provided with oil or grease as a matter of principle. It is recommended to clean those guiding rods with a dry, clean tissue on a regular basis.

Position 1 cutting head
 2 button

