

---

# OPERATION MANUAL

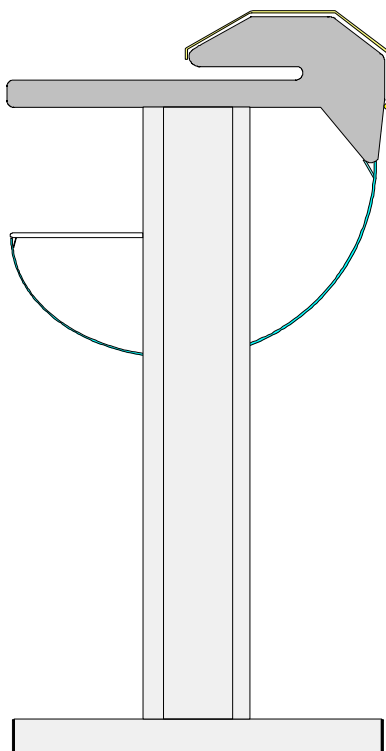

	Page
Table of contents	
<b>1.0. Safety notes</b>	2
<b>2.0. Technical data</b>	3
<b>3.0. Mounting</b>	
3.1. Set up of the side parts	4
3.2. Set up of traverse	5
3.3. Set up of the trimmer	6
3.4. Set up of reception bag	6
3.5. Set up of illumination kit	7
<b>4.0. Assembly</b>	
4.1. Assembly of the cutting head	8
4.2. Cuttable materials	8
<b>5.0. Cutting</b>	
5.1. Cutting procedure	9
<b>6.0. Trouble-shooting</b>	
6.1. Fitting of cutting blade	10
<b>Spare parts</b>	11-13
<b>Packing list</b>	14

## 1.0. SAFETY REGULATIONS

**Before the mounting and set up, the instruction manual with its safety regulations should be read and followed !**

**Make sure, that every operator is aware of this manual**

**Keep this documentation always near the machine**

**Information about machine with illumination kit (optional):**

**The connection is only allowed at an VDE-controlled Schuko socket, which is placed near the machine.**

**Do not remove any fixed srewed parts**

**Make sure, that no other parts get into the machine.**

**Before any intervention into the electrical or mechanical section of the machine, please separate the system from the power supply.**

**Pull power plug!**

**Please take care that the mains plug may be reached easily and without any danger!**

### 1.1. Saffety data sheets

**Rejection of liability:**

The following rejection of liability applies for all safety data sheets contained in this operating manual. This safety data sheet was compiled to our best knowledge and serves as a comprehensive instruction manual for a safe operation of this product. We reserve the right to update the all data sheets,if new information becomes valid. It is the task of the respective operator to judge the aptitude for these information for thecompliance with these safety measurements. If there are any doubts existing, the operator must contact the manufacturer, in order to make sure, that he has the latest technical information of the safety data sheet in hand. If and to which extent a rejection of liability, according to the applicable law, is permissible, we do not take over any responsibility for possible inaccuracies contained in this documentation.

### 1.2. General information

Warranty works will, as a matter of principle, only performed by ourselves or our authorized expertized dealers.

Have all maintenances and fixings done by the service in charge

## 2.0. TECHNICAL DATA

Space requirements:	app. 1,0 m <sup>2</sup>
Weight 150cm working width:	app. 30 kg
Weight 160cm working width:	app. kg
Weight 200cm working width:	app. kg

### Lighting equipment

Supply power:	230 V, 1NAC, 50/60 Hz
Nominal current:	0,3 A
Connection value:	65 VA
Measurements 150cm working width:	1790x1000x420 mm
Measurements 160cm working width:	1890x1000x420 mm
Measurements 200cm working width:	2290x1000x420 mm
	( Width x Height x Depth )

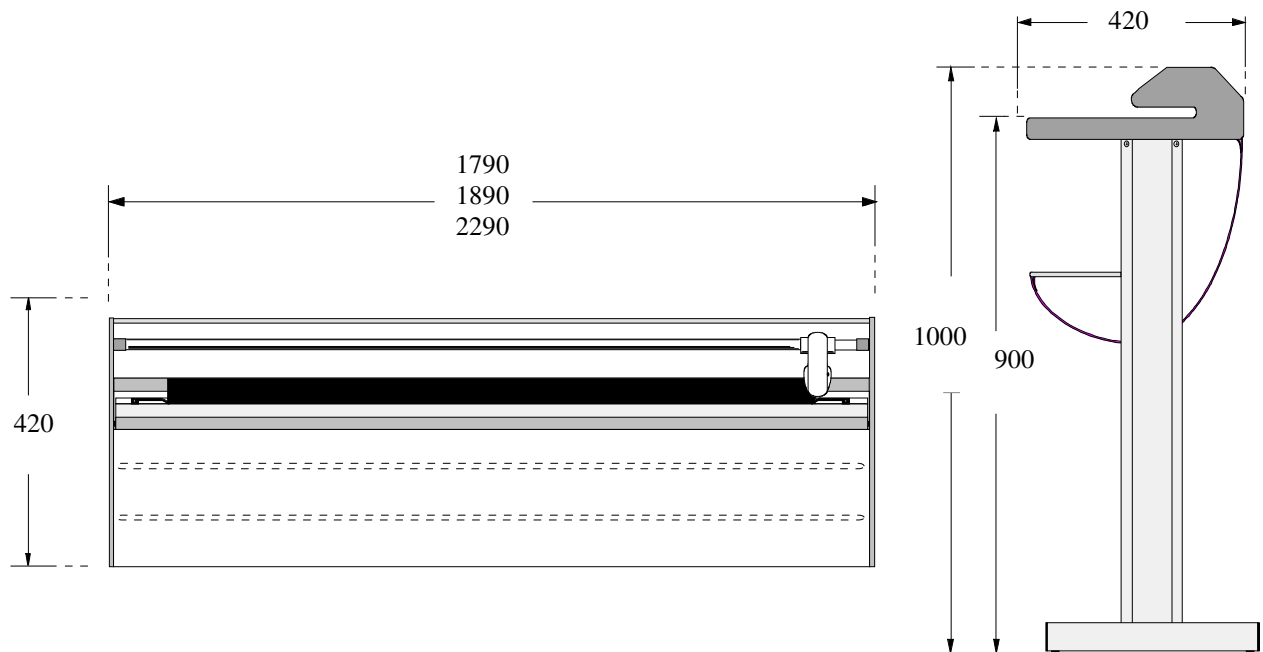

### 3.0. MOUNTING

Unpack the print trimmer as well as the parts for the stand.  
Check all parts for completeness and intactness.

**Important: For the mounting of the stand, please take care of the right sequence.**

#### 3.1. Set up of the side parts

- A) Unpack side cases.
- B) Pull mid-cover sheet out of the side cases.
- C) Put side cases with the brackets into **Pos. a** into the bottom part.
- D) Put the bearing plate **Pos. b** in the bottom part through the whole of the brackets
- E) Fix the bearing plate between the brackets and tighten the screws into the thread holes.
- F) Tighten the screws strong and set the lamella plugs.

- 1) Side part (lefthand + righthand)
- 2) mid cover sheet ( 2x )
- 3) Bottom stand ( 2x )
- 4) Bearing plate ( 2x )
- 5) Screw M5 x 16 ( 4x )
- 6) Lamella plug 45 x 45 mm ( 4x )
- 7) Lamella plug 50 x 25 mm ( 4x )

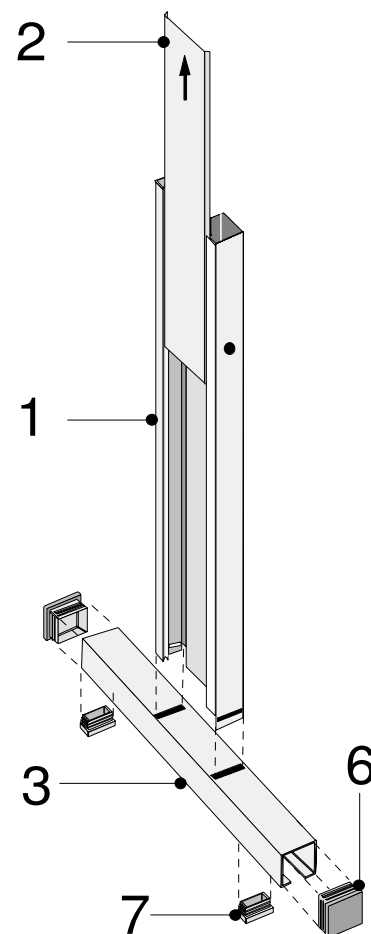
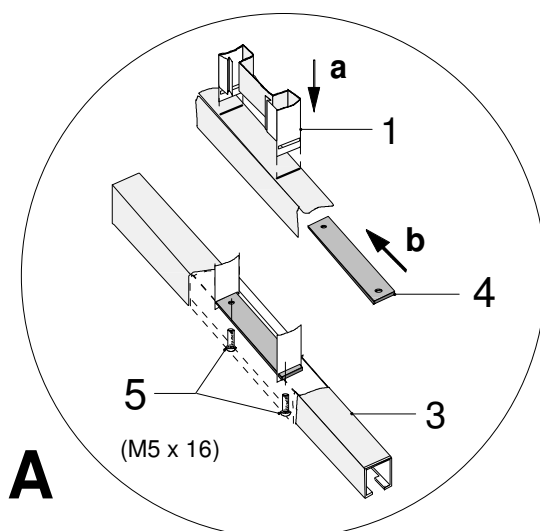

### 3.2. Set up of traverse

- A) Before going any further, remove the protection foil from the traverse and the side cases.
- B) Start at the corner sides:
- C) Put the traverse with the threaded bolt into the length hole of the side cases
- D) Screw traverse and side cases together with the bearing plate to the front side

**Important: Take care of the correct fitting position of the bearing plate.  
Long leg with drilled holes upside.  
Mount angular side forwards the inside**

- E) Screw traverse with hex-nut and serrated lock washer towards the rear side
- F) Tighten all mounting areas and put mid-cover sheet from above into the side cases.

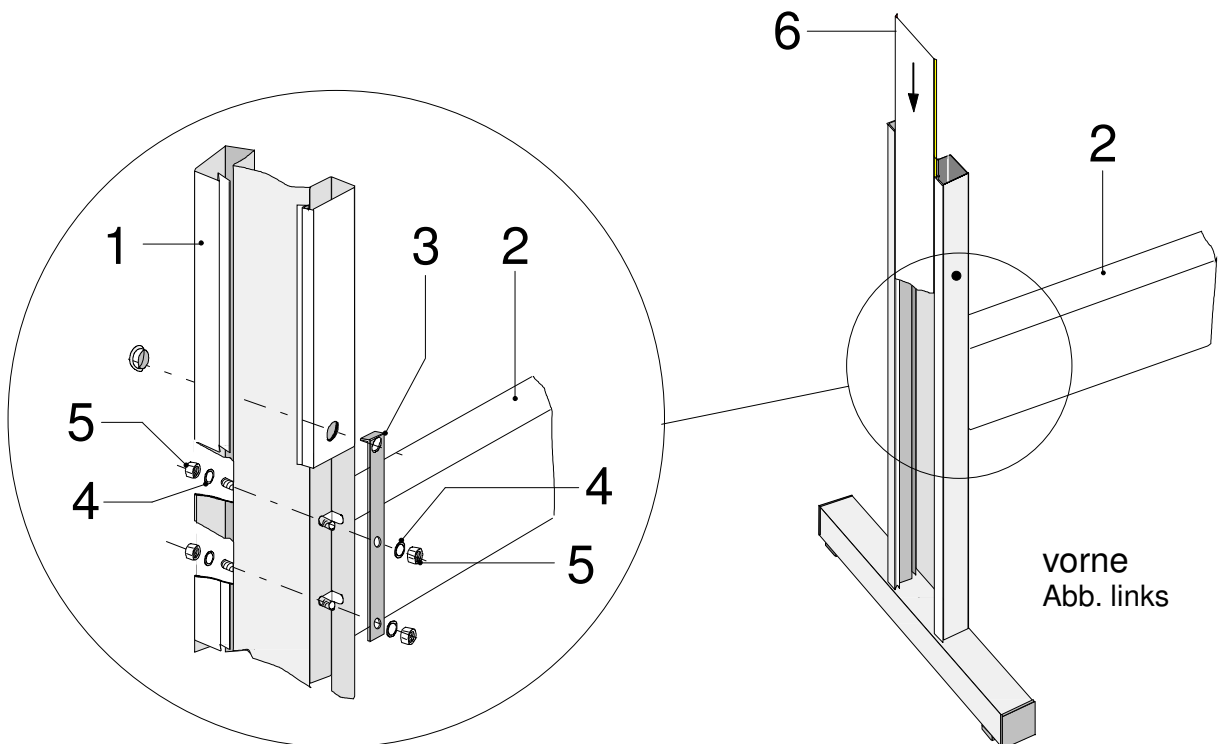

1. Side parts ( 2x )
3. Bearing plate( 2x )
5. Hex nut M5 ( 8x )

2. Traverse ( 1x )
4. Serrated lock washer J5,3 ( 8x )
6. Cover sheet ( 2x )

### 3.0. MOUNTING

#### 3.3. Set up of the trimmer

A) Put the print trimmer on the stand and screw them collateral.

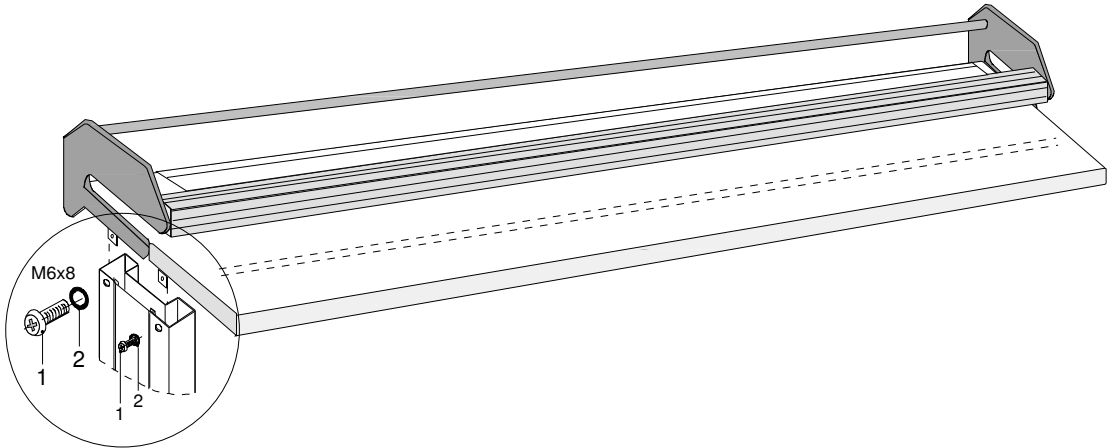

1. Oval head srew M6x8 / DIN 7985
2. Serrated lock washer J 6,4 / DIN 6798

#### 3.4. Set up of the reception bag

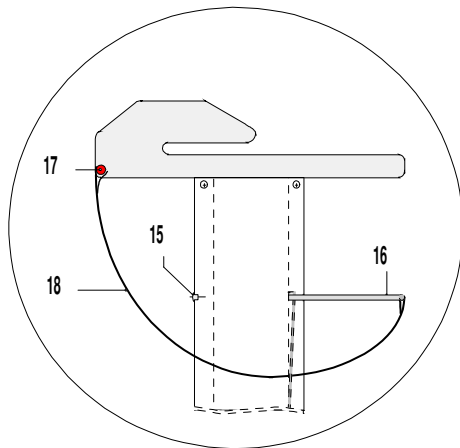

- A) Insert the front holding shackle (16) as well as the rear holding rod (17) into the collection eye of the collection box (18).
- B) Insert the frong holding shackle (16) into the bored collection holes inside the stand at the left and right hand side.
- C) Push the flat stopper (15) into the rear collection hole.
- D) Put the rear holding rod (17) from the inside into the right hand collection hole of the side plate.
- E) Put the rear holding rod (17) into the left hand collection hole of the side plate. Bend the rear holding rod (17) a bit when doing so, in order to be able to insert them inbetween the side plates.

### 3.0 MOUNTING

#### 3.5 Set up of illumination kit

Material list:

- 1. lamp
- 2. angle ( supplied with lamp )
- 3. nut ( supplied with lamp )
- 4. z-angle
- 5. rubber plug
- 6. screw
- 7. washer
- 8. serrated lock washer
- 9. hexagon nut
- 10. t-screw

A) Mount fixing angle according to sketch. For opening of the lamp, see instructions of Osram as well.

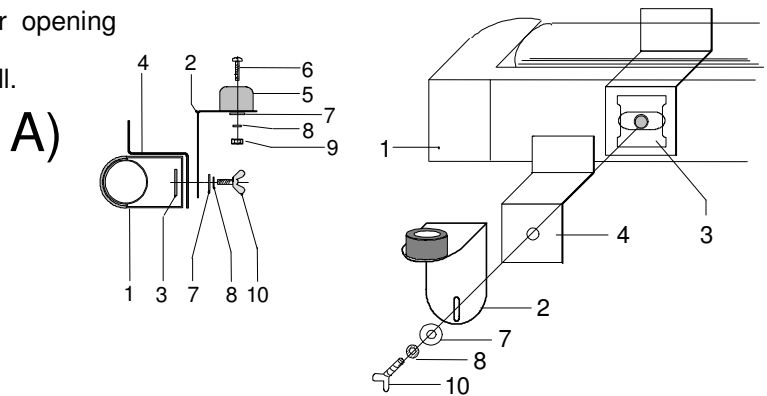

B) Put lamp with pre-mounted angles into the lower profiling.

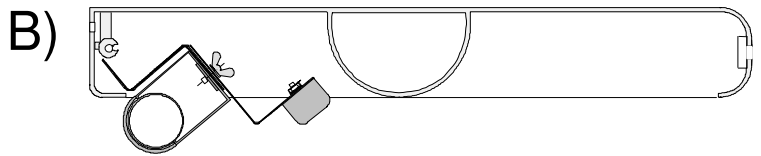

C) Swing lamp in horizontal position. Screw holding angles with rubber plugs to the upper.

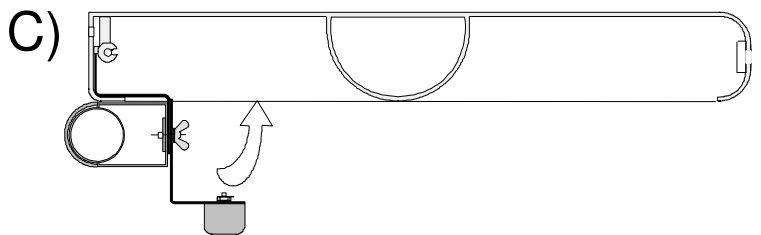

D) Press holding angles with rubber plugs against the lower side and tighten t-screw.

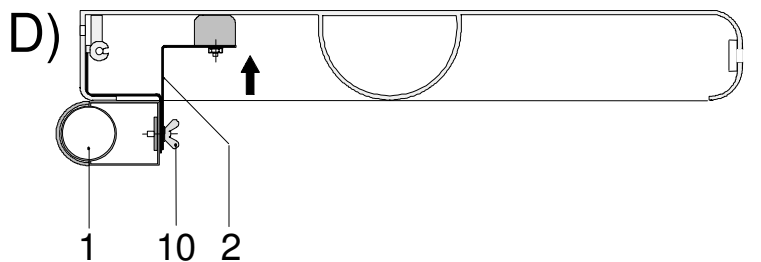

## 4.0. Assembly

### 4.1. Assembly of the cutting head

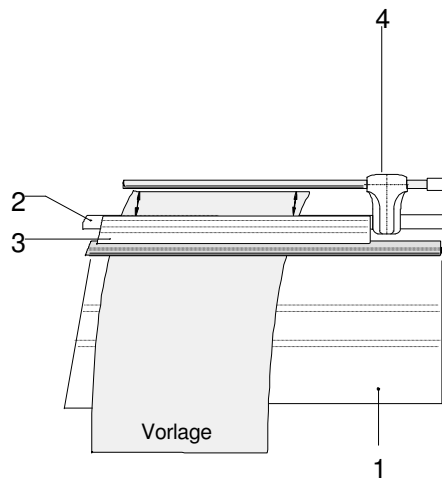

1. Table profile
2. lower cutting edge
3. Holding-down clamp
4. Cutting head
5. Mounting tools

### 4.2. Cuttable materials

- |                   |                                      |
|-------------------|--------------------------------------|
| - Paper types:    | normal paper 60-210 g/m <sup>2</sup> |
| - Carton          | max: 1 mm / thickness                |
| - PE / Foil       | max. 0,5 mm / thickness              |
| - Transparencies: | max. 210 g/m <sup>2</sup>            |



## 5.0. CUTTING

### 5.1. Cutting procedure

The holding-down clamp is lifted by the cutting head only in the respective final position

Shift the pattern over the cutting edge

Fix the cutting edge desired.

Hold the pattern with one hand on the table board and move the cutting head on the other side. During the cut, the holding-down clamp will press the pattern at the lower knife and safes an exact cut.

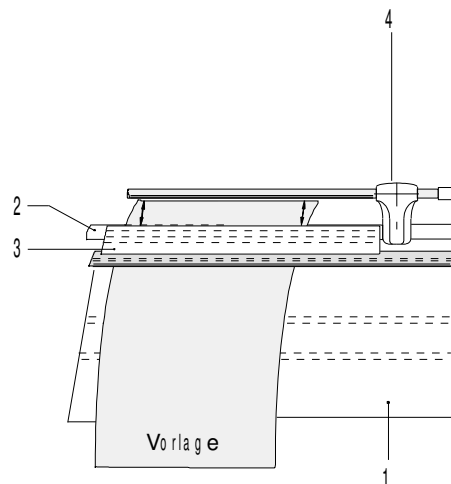

1. Table profile
2. Lower cutting edge
3. Holding-down clamp
4. Cutting tools

## 6.0. TROUBLE SHOOTING

### 6.1. Feeding of cutting blade

If the cutter (revolving blade) has run onto the lower cutter, it may be put back into its correct position.

Push cutting head into the middle of the device

Push the button on front of cutting head (marked position)  
At the same time, push cutting head backwards with your other hand

Whipping of the guiding tubes furthers the guiding

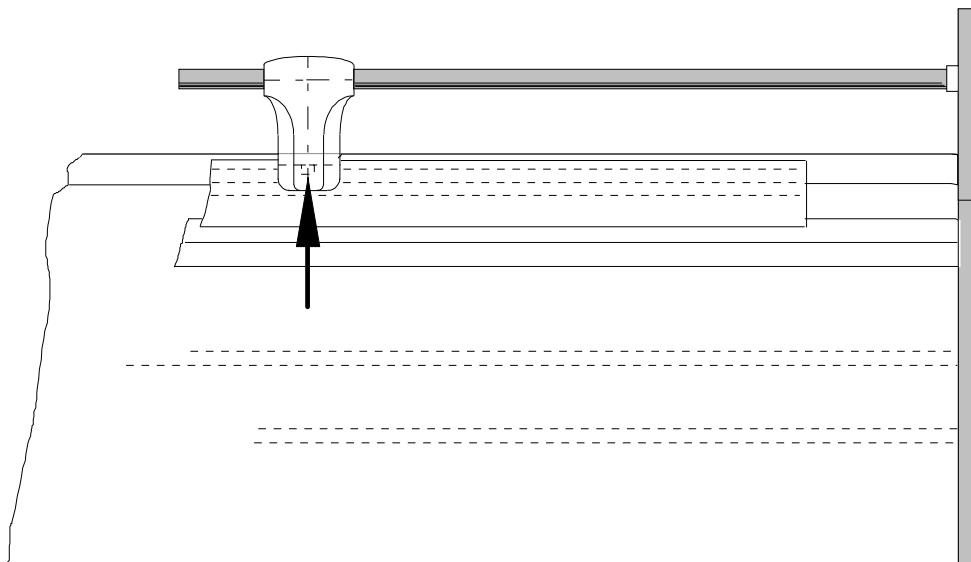

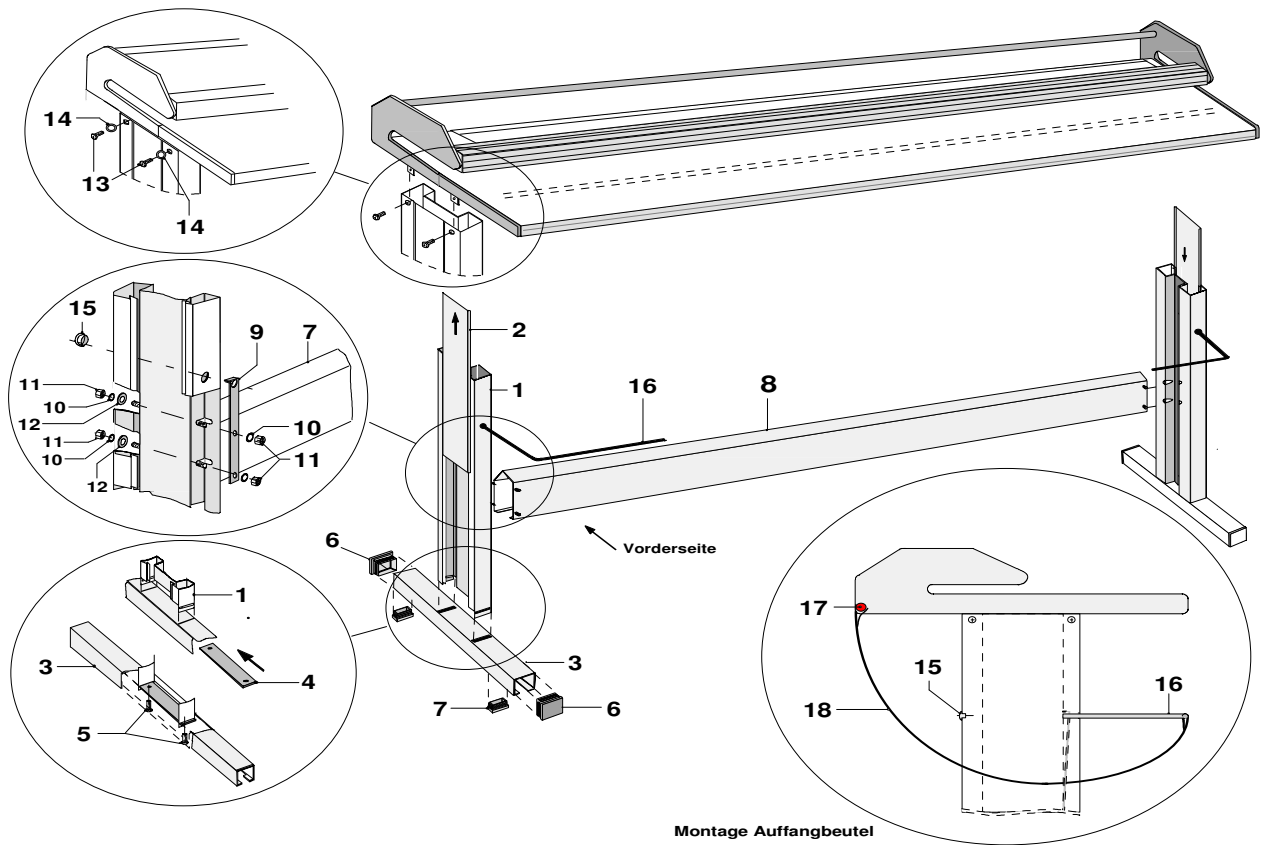

Montage Auffangbeutel

Pos.	Ersatzteil-Nr.	Bezeichnung	Description	Stück
1	ET 14 / 00/ 758	Seitenteil ( links + rechts )	Side part ( lefthand + righthand )	2
2	ET 14 / 00/ 755	Abdeckblech	Cover sheet	2
3	ET 14 / 00/ 756	Fußteil	Bottom stand	2
4	ET 13 / 00/ 590	Flacheisen, 140x28 mm	Bearing plate 140x28 mm	2
5	ET 01 / 00/162	Linsenkopfschraube M5x16 / DIN 7985	Oval head screw M5x16 / DIN 7985	4
6	ET 22 / 00/ 089	Lamellen-Stopfen 45x45 mm	Lamelle plug 45x45 mm	4
7	ET 22 / 00/ 088	Lamellen-Stopfen 50x25 mm	Lamelle plug 50x25 mm	4
8	ET 14 / 00/ 757	Traverse (150cm Arbeitsbreite)	Traverse (150cm working width)	1
8a	ET 14 / 01/ 043	Traverse (160cm Arbeitsbreite)	Traverse (160cm working width)	1
8b	ET 14 / 01/ 052	Traverse (200cm Arbeitsbreite)	Traverse (200cm working width)	1
9	ET 13 / 00/ 591	Flacheisen, 305x20 mm	Bearing plate 305x20 mm	2
10	ET 01 / 00/ 085	Fächerscheibe J 5,3 / DIN 6798	Serrated lock washer J 5,3 / DIN 6798	8
11	ET 01 / 00/ 061	S-Mutter M5 / DIN 934	hexagon nut M5 / DIN 934	8
12	ET 01 / 00/ 164	U-Scheibe 5,3 / DIN 9021	washer 5,3 / DIN 9021	2
13	ET 01 / 00/ 163	Linsenkopfschraube M6x8 / DIN 7985	Oval head screw M6x8 / DIN 7985	4
14	ET 01 / 00/ 034	Fächerscheibe J 6,4 / DIN 6798	Serrated lock washer J 6,4 / DIN 6798	4
15	ET 22 / 00/ 090	Verschluß-Stopfen D=15/10 , weiß	Lamella plug round D= 15/10	2
16	ET 14 / 00/ 752	Haltebügel (150cm Arbeitsbreite)	Holding clamp (150cm working width)	1
16a	ET 14 / 01/ 044	Haltebügel (160cm Arbeitsbreite)	Holding clamp (160cm working width)	1
16b	ET 14 / 01/ 053	Haltebügel (200cm Arbeitsbreite)	Holding clamp (200cm working width)	1
17	ET 14 / 00/ 753	Haltestange (150cm Arbeitsbreite)	Holding axle (150cm working width)	1
17a	ET 14 / 01/ 045	Haltestange (160cm Arbeitsbreite)	Holding axle (160cm working width)	1
17b	ET 14 / 01/ 054	Haltestange (200 cm Arbeitsbreite)	Holding axle (200cm working width)	1
18	ET 32 / 00/ 102	Auffangbeutel (150cm Arbeitsbreite)	Reception bag (150cm working width)	1
18a	ET 32 / 00/ 102	Auffangbeutel (160cm Arbeitsbreite)	Reception bag (160cm working width)	1
18b	ET 32 / 00/ 145	Auffangbeutel (200cm Arbeitsbreite)	Reception bag (200cm working width)	1

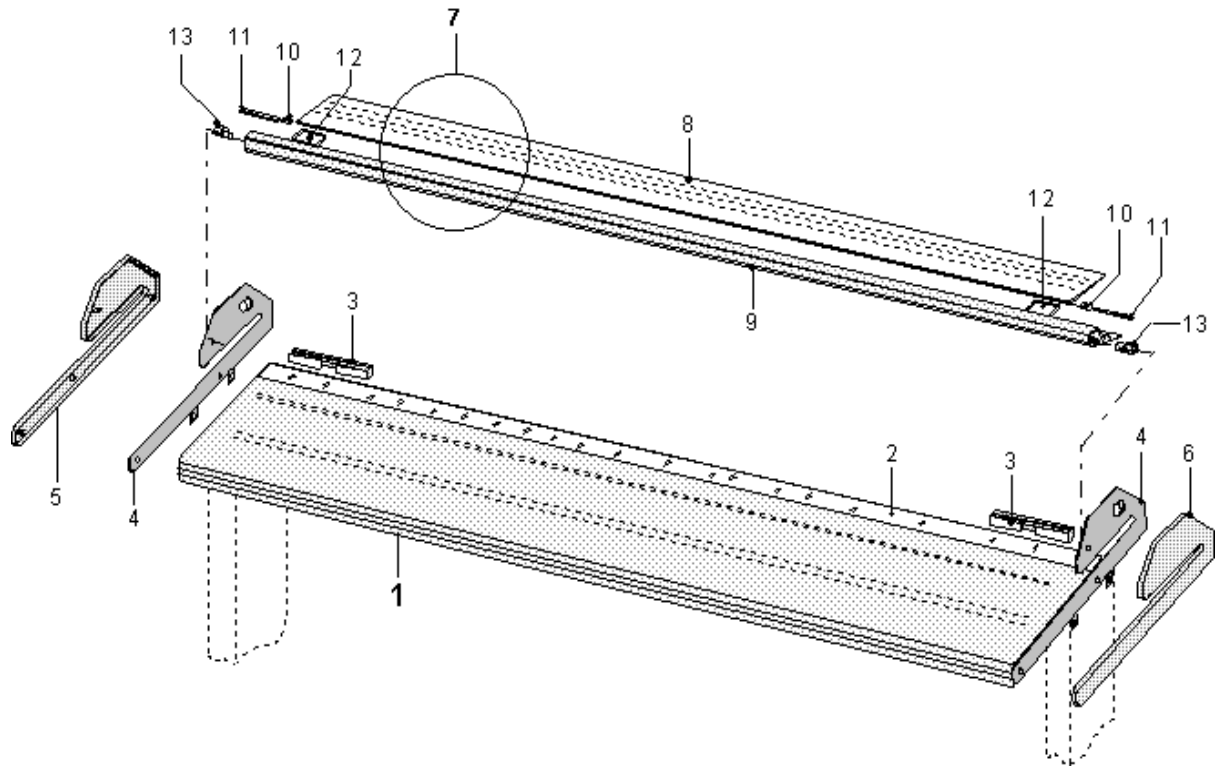

Pos.	Ersatzteil-Nr.	Bezeichnung	Description	Stück
1	ET 12/ 00/ 121	Tischprofil kpl. (150cm Arbeitsbreite)	table profile compl.	1
1a	ET 12/ 00/ 140	Tischprofil kpl. (160cm Arbeitsbreite)	table profile compl.	1
1b	ET 12/ 00/ 143	Tischprofil kpl. (200cm Arbeitsbreite)	table profile compl.	1
2	ET 16/ 00/ 019	Untermesser (150cm Arbeitsbreite)	lower blade	1
2a	ET 16/ 00/ 025	Untermesser (160cm Arbeitsbreite)	lower blade	1
2b	ET 16/ 00/ 026	Untermesser (200cm Arbeitsbreite)	lower blade	1
3	ET 24 / 00/ 033	Auflaufleiste 120 mm lg.	stop wedge	2
4	ET 14 / 00/ 729	Seitenteil, ( links / rechts )	side plate ( li / re )	2
5	ET 22 / 00/ 079	Seiten-Abdeckung , links	side box , left-hand	1
6	ET 22 / 00/ 081	Seiten-Abdeckung , rechts	side box , right-hand	1
7	ET 15 / 00/ 245	Niederhalter kpl. (150cm Arbeitsbreite)	pressure pad, compl.	1
7a	ET 15 / 00/ 310	Niederhalter kpl. (160cm Arbeitsbreite)	pressure pad, compl.	1
7b	ET 15 / 00/ 312	Niederhalter kpl. (200cm Arbeitsbreite)	pressure pad, compl.	1
8	ET 22 / 00/ 080	Plexiglasscheibe (150cm Arbeitsbreite)	plexiglass disc	1
8a	ET 22/ 00/ 098	Plexiglasscheibe (160cm Arbeitsbreite)	plexiglass disc	1
8b	ET 22 / 00/ 099	Plexiglasscheibe (200cm Arbeitsbreite)	plexiglass disc	1
9	ET 12/ 00/ 122	Alu-Profil (150cm Arbeitsbreite)	Alu-profil	1
9a	ET 12/ 00/ 142	Alu-Profil (160cm Arbeitsbreite)	Alu-profil	1
9b	ET 12/ 00/ 143	Alu-Profil (200cm Arbeitsbreite)	Alu-profil	1
10	ET 05 / 00/ 085	Druckfeder	pressure spring	2
11	ET 00 / 00/ 083	Kerbstift 6 x 80 mm / DIN 1472	pin 6 x 80 mm	2
12	ET 24 / 00/ 035	Auflaufkeil	stop wedge	2
13	ET 11 / 00/ 526	Exzenterbolzen SW 10 x 19	excentric pin sw 10 x 19	2

**Baugruppe: Messerkopf**

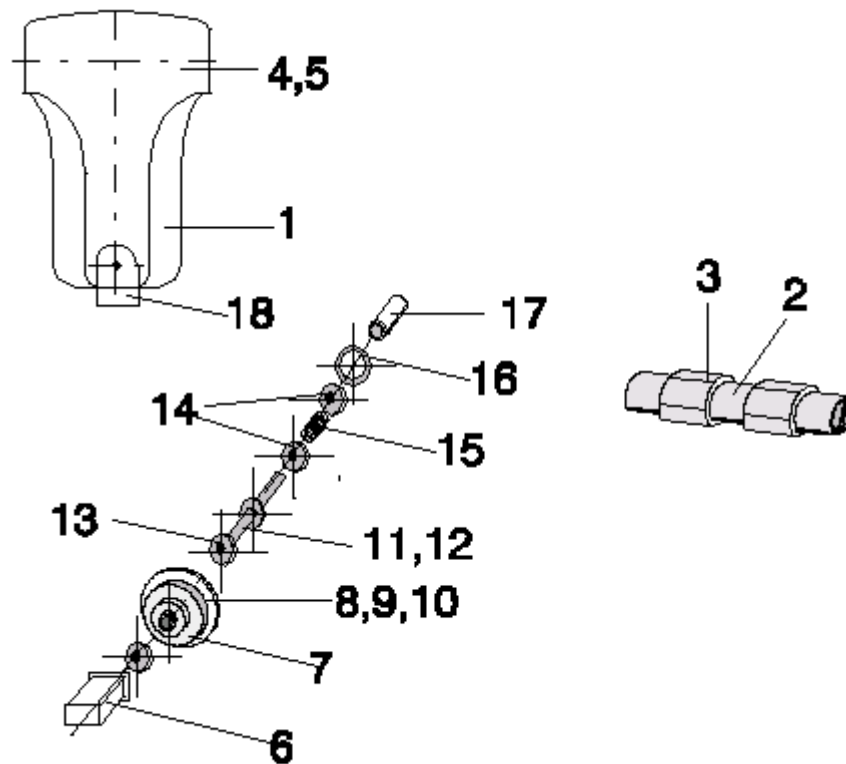

Pos.	Ersatzteil-Nr.	Bezeichnung	Description	Stück
1	ET 15/00/301	Messerschlitten kpl. montiert	Cutting head complete mounted	1
2	ET 11/00/633	Führungswelle	Guide shaft	1
3	ET 15/00/302	Führungshülse kpl.	Guide bush, complete	2
4	ET 24/00/036	Gehäuseunterteil	Cower, lower part	1
5	ET 24/00/037	Gehäuseoberteil	Cower, upper part	1
6	ET 18/00/050	Druckknopf	Press button	1
7	ET 15/00/303	Schneidemesser kpl. montiert	Cutting knife compl. mounted	1
8	ET 16/00/022	Kreismesser	Round knife	1
9	ET 09/00/107	Gummirolle	Rubber roll	1
10	ET 04/00/046	Buchse	bush	1
11	ET 00/00/093	Zylinderstift d 6x60	Cylinder pin d6x60	1
12	ET 00/00/096	Greifring G6x1	Grip ring G6x1	1
13	ET 00/00/095	Paßscheibe d6x12x0,1	Shim ring d6x12x0,1	2
14	ET 00/00/046	Scheibe d6,4/Messing	Disk d 6,4/brass	2
15	ET 05/00/083	Druckfeder	Pressure spring	1
16	ET 00/00/094	Paßscheibe d12x18x1	Shim ring d12x18x1	1
17	ET 04/00/047	Buchse	bush	1
18	ET 24/00/038	Führungsplatte	Guide plate	1



**Packliste für Beschneidegerät**  
**Packing list for print trimmer**

**Vor Montage des Beschneidegerätes**  
**alle Teile auf Vollständigkeit und**  
**Unversehrtheit hin überprüfen.**

Before mounting the print trimmer,  
check all parts for completeness  
and intactness

**Materialiste**  
**Material list**

- 1.) **Beschneidegerät (1x)**  
*Print trimmer*
- 2.) **Fußteil (2x)**  
*bottom stand*
- 3.) **Traverse (1x)**  
*traverse*
- 4.) **Seitenteil (2x)**  
*side case*
- 5.) **Haltebügel (1x)**  
*holding clamp*
- 6.) **Beutel mit Kleinteilen**  
*bag with small parts*
- 7.) **Auffangbeutel (1x)**  
*reception bag*
- 8.) **Verpackung**  
*package*
- 9.) **Flacheisen, lang 310 x 20mm (2x)**  
*bearing plate, long*

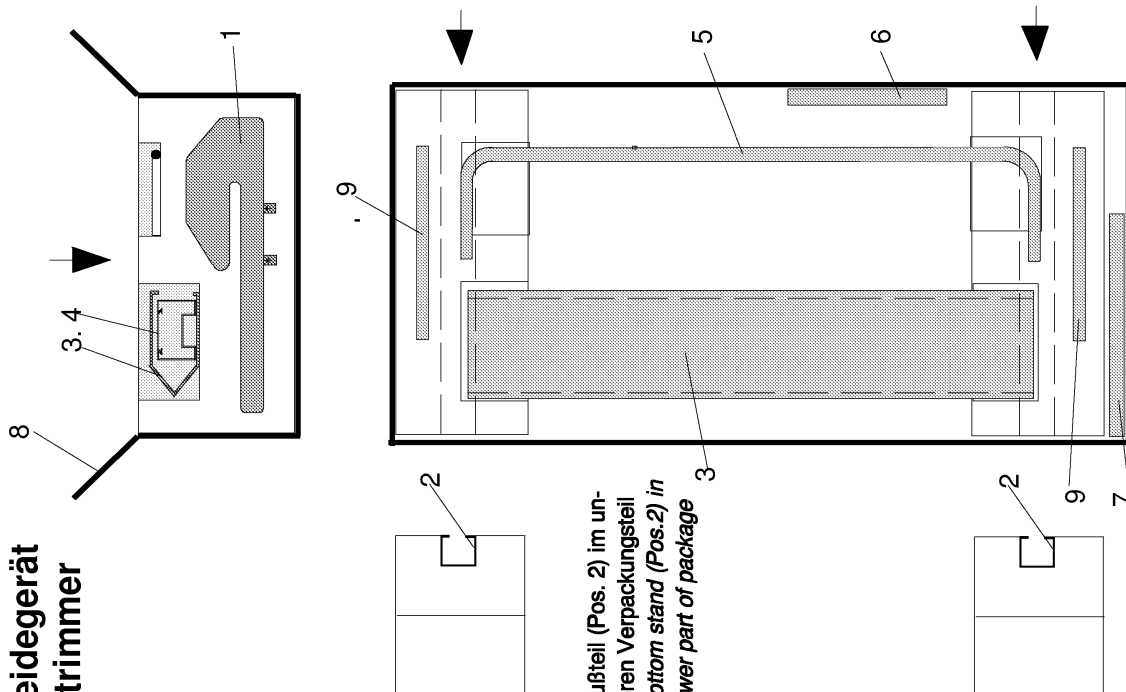

Fußteil (Pos. 2) im unteren Verpackungsteil  
*Bottom stand (Pos.2) in lower part of package*

**6.) Musterbeutel**

Inhalt/Content:

- a.) 2x Flacheisen, kurz ca. 140 x 28 mm  
*bearing plate, short*
- d.) 2x Lamellen-Stopfen, rund  
*lamella plug, round*
- e.) 4x Linsenschraube M5 x 16 / DIN7985  
*lenticular screw M5x16/DIN7985*
- f.) 8x Fächerscheibe J5,3 / DIN6798  
*washer J5,3 / DIN6798*
- g.) 8x Sechskantmutter M5 / DIN934  
*hexagonal nut M5 / DIN 934*
- h.) 4x U-Scheibe 5,3 / DIN9021  
*washer 5,3 / DIN 9021*
- i.) 4x Linsenschraube M6 x 8 / DIN7985  
*lenticular screw M6x8 / DIN7985*
- j.) 4x Fächerscheibe J6,4 / DIN6798  
*washer J6,4 / DIN6798*

